

ELEMENT 180/220-240/12 G2 (NEW)

ELEMENT G2 12V | Constant Voltage – Non dimmable

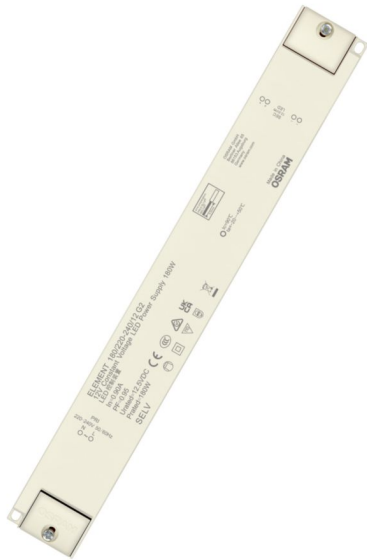

Product family features

- Linear form factor
- Power factor: >0.95 at full load
- Total Harmonic Distortion (THD): < 15%
- Output voltage tolerance: < 3%
- Up to 30,000 h @ T_c max / up to 50,000 h @ T_c -10 °C
- Lifetime: up to 30,000 h (temperature at max. t_c)

Product family benefits

- High efficiency (up to 91 %)
- Higher quality of light thanks to < 3% output ripple current
- Excellent price/performance ratio
- Class II design for wide application
- 3 years guarantee

Areas of application

- Decorative lighting in hospitality, restaurants and Shops
- Shelf lighting
- Cove lighting
- Under cabinet lighting

Technical data

Electrical data

| | |
|---|----------------------|
| Nominal input voltage | 220...240 V |
| Mains frequency | 50...60 Hz |
| Input voltage AC | 198...264 V |
| Power factor λ | > 0.95 |
| Efficiency in full-load | 91 % ¹⁾ |
| Device power loss | 17.8 W ²⁾ |
| Inrush current | < 70 A ³⁾ |
| Max. ECG no. on circuit breaker 10 A (B) | 3 |
| Max. ECG no. on circuit breaker 16 A (B) | 6 |
| Surge capability (L/N-Ground) | 2 kV |
| Surge capability (L-N) | 1 kV |
| Nominal output voltage | 12.5 V |
| Nominal output power | 180 W |
| Maximum output power | 180 W |
| Galvanic isolation | SELV |

1) at 230 V, 50 Hz

2) At Full load, 230 V, 50 Hz

3) Max, $t_h = 240\mu s$

Dimensions & weight

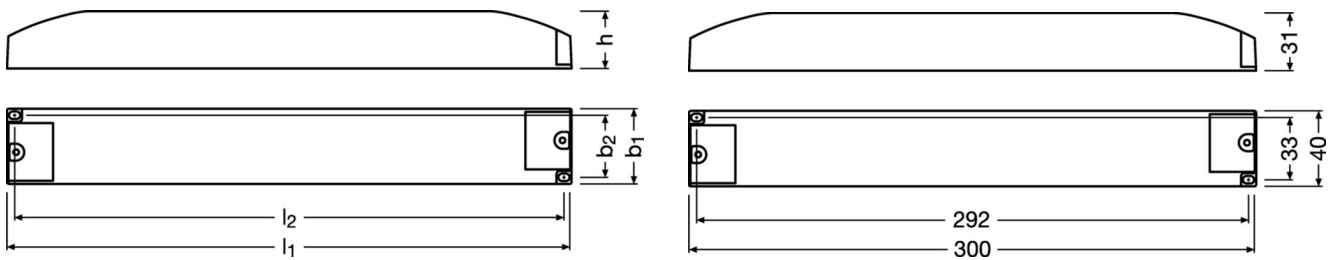

| | |
|--|----------------------------|
| Length | 300.0 mm |
| Width | 40.0 mm |
| Height | 31.0 mm |
| Cable cross-section, input side | 0.75...1.5 mm ² |
| Cable cross-section, output side | 0.5...1.5 mm ² |
| Wire preparation length, input side | 5.0 mm |
| Product weight | 540.00 g |

Colors & materials

| | |
|------------------------|---------|
| Casing material | Plastic |
|------------------------|---------|

Temperatures & operating conditions

| | |
|---|------------------------|
| Ambient temperature range | -20...+50 °C |
| Maximum temperature at tc test point | 90 °C |
| Max.housing temperature in case of fault | 110 °C |
| Temperature range at storage | -40...+85 °C |
| Permitted rel. humidity during operation | 5...85 % ¹⁾ |

1) Maximum 56 days/year at 85 %

Lifespan

| | |
|---------------------|-----------------------|
| ECG lifetime | 30000 h ¹⁾ |
|---------------------|-----------------------|

1) At maximum T_c / 10% failure rate

Capabilities

| | |
|---|---------------------|
| Dimmable | No |
| Max. cable length to lamp/LED module | 3.0 m ¹⁾ |
| Suitable for fixtures with prot. class | I / II |
| Number of channels | 1 |
| Short-circuit protection | Yes |
| Intended for no-load operation | No |

1) Output wires must be routed as close as possible to each other

Certificates & standards

| | |
|----------------------------------|--|
| Approval marks – approval | BIS / CCC / CE / MM / RCM / UKCA |
| Standards | Acc. to EN 61347-1 / Acc. to EN 61347-2-13 / Acc. to EN 55015 / Acc. to EN 61547 / Acc. to EN 60598-1 / Acc. to EN 62384 / Acc. to CISPR 15 / Acc. to EN 61000-3-2/IEC 61000-3-2 |
| Type of protection | IP20 |

Logistical data

| | |
|-----------------------|-------------|
| Commodity code | 85044083900 |
|-----------------------|-------------|

Environmental information

| Information according Art. 33 of EU Regulation (EC) 1907/2006 (REACH) | |
|---|---------------|
| Date of Declaration | 24-05-2024 |
| Primary Article Identifier | 4062172277907 |
| Declaration No. in SCIP database | In work |
| SCIP_STATUS | In work |
| SCIP_ID | |

Download Data

| File | | |
|------------------------|-----|---------------------------------------|
| Mandatory Publications | PDF | ▶ELEMENT 12V G2 CE 4399675 04 240724 |
| Mandatory Publications | PDF | ▶ELEMENT 12V G2 UKD 4438367 02 240724 |
| User instruction | PDF | ▶ELEMENT G2 |

Logistical Data

| Product code | Product description | Packaging unit (Pieces/Unit) | Dimensions (length x width x height) | Volume | Gross weight |
|---------------|---------------------------|----------------------------------|--------------------------------------|-----------------------|--------------|
| 4062172277907 | ELEMENT 180/220-240/12 G2 | Shipping carton box 20 Pieces | 421 x 325 x 105 mm | 14.37 dm ³ | 571.50 g |

The mentioned product code describes the smallest quantity unit which can be ordered. One shipping unit can contain one or more single products. When placing an order, for the quantity please enter single or multiples of a shipping unit

Disclaimer

Subject to change without notice. Errors and omission excepted. Always make sure to use the most recent release.